

RH5X RELATIVE HUMIDITY SENSOR

TECHNICAL PRODUCT SHEET

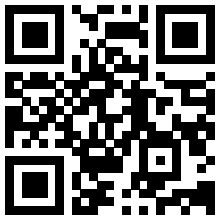

[Click for RH5X Video](#)

Overview

The RH5X features a polymer resistor sensor, which provides excellent linearity and sensitivity with fast response time and long-term stability. It mounts to the underside of a shelter box and includes 1.5 m (5') of cable, a mounting bracket, and one hose clamp.

Specifications

Measurement Range	0 to 100% relative humidity (non-condensing)
Signal Type	Linear analog voltage
Transfer Function	Default Slope: voltage x 20 Default Offset: 0
Output Signal	0 to 5 V for 0 to 100% RH
Supply Voltage	10 V to 30 V DC
Supply Current	12 V at 2.6 mA typical
Mounting	Uses a sheet metal bracket with a hose clamp, to be mounted to the tower, under the shelter box

Tools Required

- 8 mm (5/16 inch) nut driver or wrench (electric nut driver preferred)
- Small NRG screw driver
- Sheet metal shears (for trimming hose clamps)

RH5X Relative Humidity Sensor Installation Process

1. Thread the provided hose clamp through the holes in the center of the mounting bracket.
2. Wrap the hose clamp around the tower, placed under the shelter box. Make sure the sensor's protective cone is facing down. Tighten the hose clamp with nut driver until the sensor is secure. Do not over-tighten.
3. Trim the end of the hose clamp, or secure it in place so it does not move freely.
4. Wire the sensor cable into the data logger.
5. Program SymphoniePRO Logger.

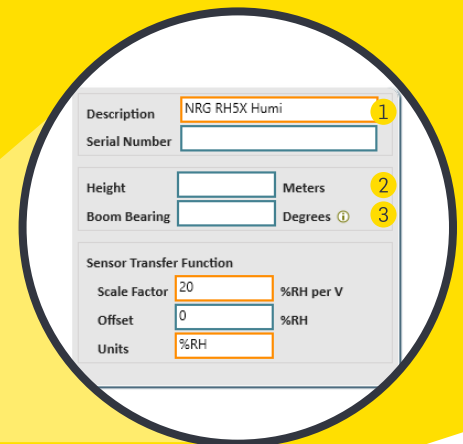
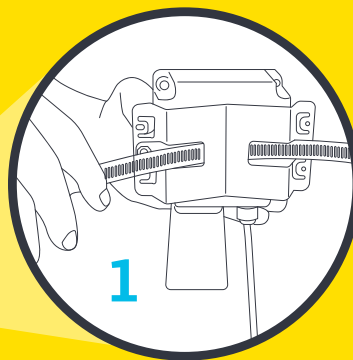
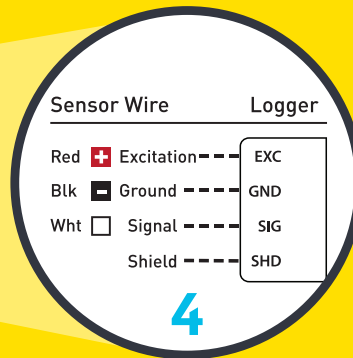
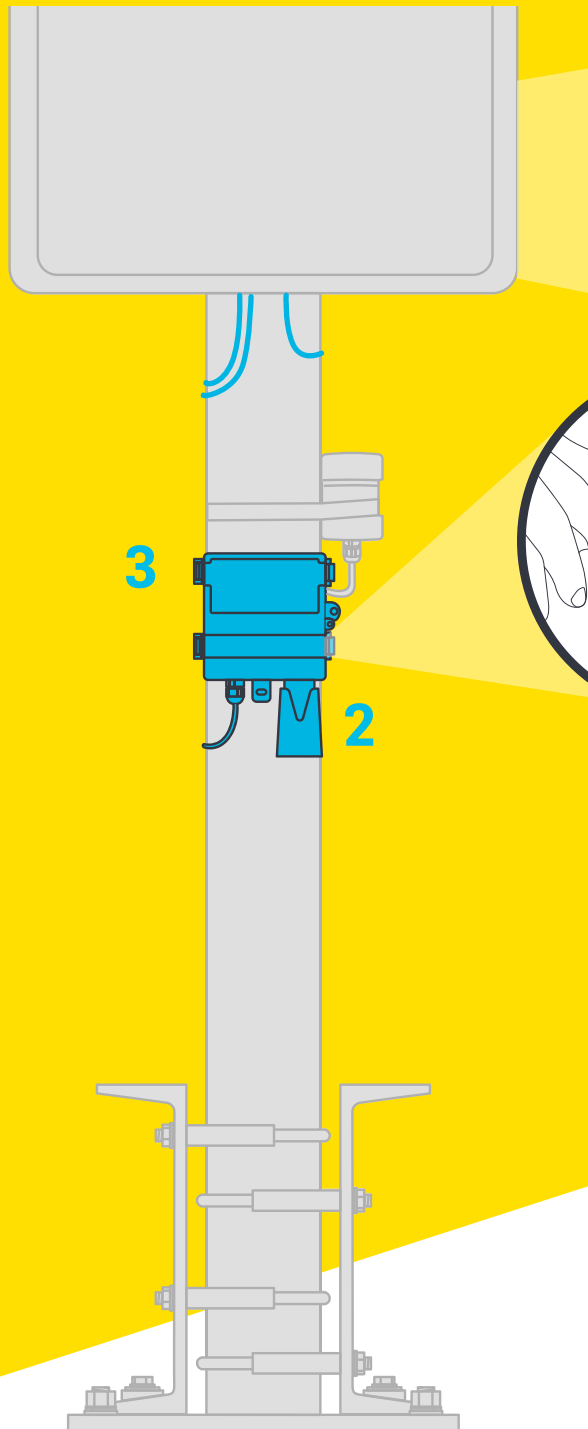

SymphoniePRO Logger Programming

Use the SymphoniePRO Desktop Application to program the sensor settings into the data logger:

1. Choose "NRG RH5X Humidity" from the "Load From Defaults" drop-down menu.
2. Enter the height of sensors from the ground.
3. Enter the direction the sensor is installed on the tower.
4. Save the setting to the logger.

For more information:

NRG Technical Support
+1 802.482.2255
support@nrgsystems.com
nrgsystems.com
ISO 9001: 2015 Certified
ISO 14001: 2015 Self-Certified